

LIST OF MATERIALS

QTY	SYMBOL	DESCRIPTION	MANUFACTURER	REMARKS
1	3	OVHD FIXTURE, INCANDESCENT, WT. 100W	PAULLIN 733A	
2	4	SWITCH, NMT, DP, FLUSH MTD	PAULLIN 2302AF	
3	11	SWITCH, NMT, DP, SURFACE MTD	PAULLIN 2302A	
4	1	SWITCH, NMT, 3WAY, FLUSH MTD	PAULLIN 2302AF	
5	1	SWITCH, NMT, 3WAY, SURFACE MTD	PAULLIN 2302A	
6	2	1/2" NMT	HOFFMAN	SUPPLIED BY HALTER
7	2	1/2" NMT	HOFFMAN	SUPPLIED BY HALTER
8	21	RECEPT, DURALEX, WT. 3W, 1/2" GAND	PAULLIN 2302A	
9	22	RECEPT, DURALEX, WT. 3W, 1/2" GAND	PAULLIN 2302A	
10	23	RECEPT, DURALEX, WT. 3W, 1/2" GAND	PAULLIN 2302A	
11	24	RECEPT, DURALEX, WT. 3W, 1/2" GAND	PAULLIN 2302A	
12	25	RECEPT, DURALEX, WT. 3W, 1/2" GAND	PAULLIN 2302A	
13	26	RECEPT, DURALEX, WT. 3W, 1/2" GAND	PAULLIN 2302A	
14	27	RECEPT, DURALEX, WT. 3W, 1/2" GAND	PAULLIN 2302A	
15	28	RECEPT, DURALEX, WT. 3W, 1/2" GAND	PAULLIN 2302A	
16	29	RECEPT, DURALEX, WT. 3W, 1/2" GAND	PAULLIN 2302A	
17	30	RECEPT, DURALEX, WT. 3W, 1/2" GAND	PAULLIN 2302A	
18	31	RECEPT, DURALEX, WT. 3W, 1/2" GAND	PAULLIN 2302A	
19	32	RECEPT, DURALEX, WT. 3W, 1/2" GAND	PAULLIN 2302A	
20	33	RECEPT, DURALEX, WT. 3W, 1/2" GAND	PAULLIN 2302A	
21	34	RECEPT, DURALEX, WT. 3W, 1/2" GAND	PAULLIN 2302A	
22	35	RECEPT, DURALEX, WT. 3W, 1/2" GAND	PAULLIN 2302A	
23	36	RECEPT, DURALEX, WT. 3W, 1/2" GAND	PAULLIN 2302A	
24	37	RECEPT, DURALEX, WT. 3W, 1/2" GAND	PAULLIN 2302A	
25	38	RECEPT, DURALEX, WT. 3W, 1/2" GAND	PAULLIN 2302A	
26	39	RECEPT, DURALEX, WT. 3W, 1/2" GAND	PAULLIN 2302A	
27	40	RECEPT, DURALEX, WT. 3W, 1/2" GAND	PAULLIN 2302A	
28	41	RECEPT, DURALEX, WT. 3W, 1/2" GAND	PAULLIN 2302A	
29	42	RECEPT, DURALEX, WT. 3W, 1/2" GAND	PAULLIN 2302A	
30	43	RECEPT, DURALEX, WT. 3W, 1/2" GAND	PAULLIN 2302A	

1. ALL GENERAL USE LIGHTING FIXTURES, SWITCHES, RECEPTACLES, LABELS, SHOWING FIXTURES ARE SUITABLE FOR MARINE USE.
2. EMERGENCY LIGHTS SHALL BE MARKED IN HEIGHT, LIGHT & CIRCUITRY SHALL BE LABELLED.
3. NATAL TYPE FASTENERS TO BE MTD TO ON PIPE & LONG W/ 50' PORTABLE COAD.
4. ALL WIRING & CIRCUITRY SHALL BE LABELLED.
5. WIRING IN QUARTERS, MESS HALL, WALLETS, LABS, CATERING, SHALL BE CONCEALED.
6. ALL BLDG. DECK PENETRATIONS SHALL BE MADE WITH RAIN-PROOF TERMINAL TUBES.
7. SURROUNDING SHALL CONFORM WITH U.S.C. & I.E.E.C. COLLATIONS, PROVIDE GROMMETS IN LAB & PILOT HOUSE. PROVIDE DIELECTRIC MATING IN LAB & PILOT HOUSE IN FRONT OF ELECTRICAL CABINETS.
8. PANEL BOARD LAYOUT ON DWG. E-1, DESCRIPTION OF PANEL BOARD IN BILL OF MATERIALS ON DWG. E-2.

APPROVALS

U.S. NAVAL SHIP SYSTEMS COMMAND  
WASHINGTON D.C. 20380

OCEANOGRAPHIC RESEARCH SHIP  
AGOR (UTILITY) CLASS

HALTER MARINE SERVICES, INC.  
P.O. BOX 23266 NEW ORLEANS, LA. 70129

LIGHTING DECK PLANS

SCALE: 1/4" = 1'-0"

DATE: 10/27/72

HALTER

DRAWN BY: 375

CKD BY: EDB: MRE

HALTER

HULL NO. 376

JOB NO. 1087-203

NAVSHIPS NO. AGO 21-303-001

REV. 15

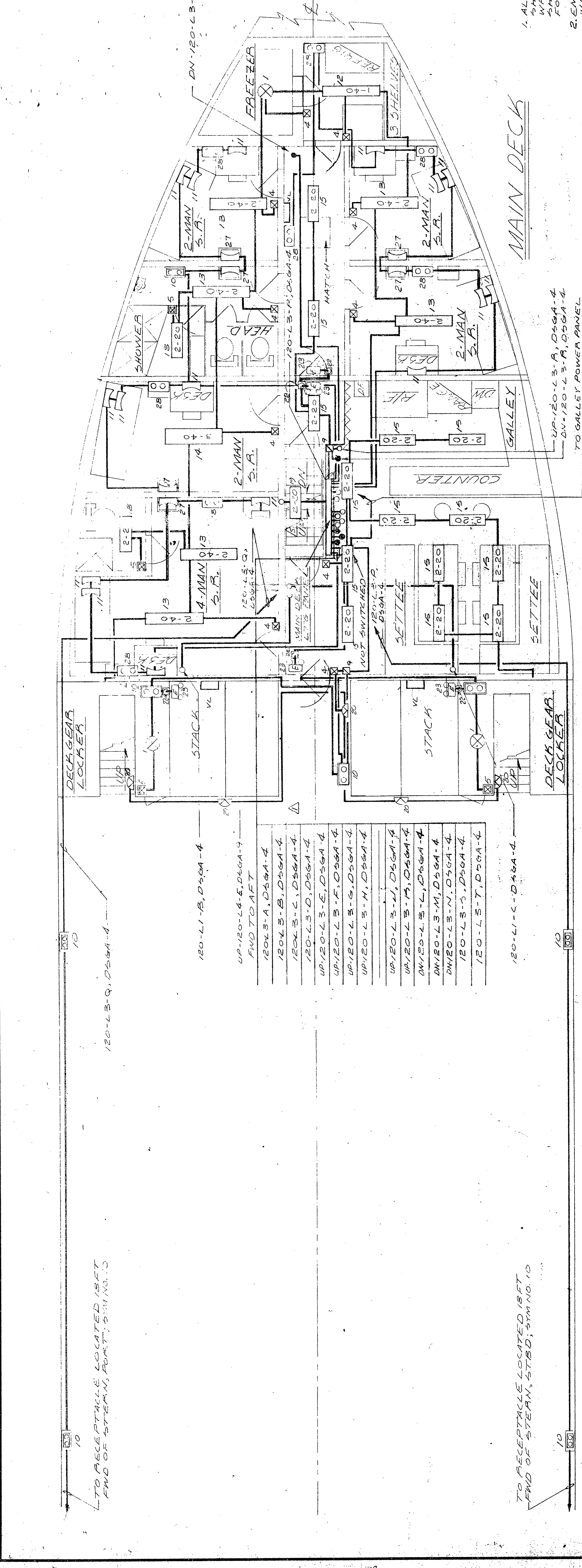

1. ALL GENERAL USE LIGHTING FIXTURES, SWITCHES, RECEPTACLES, LABELS, SHOWING FIXTURES ARE SUITABLE FOR MARINE USE.
2. EMERGENCY LIGHTS SHALL BE MARKED IN HEIGHT, LIGHT & CIRCUITRY SHALL BE LABELLED.
3. NATAL TYPE FASTENERS TO BE MTD TO ON PIPE & LONG W/ 50' PORTABLE COAD.
4. ALL WIRING & CIRCUITRY SHALL BE LABELLED.

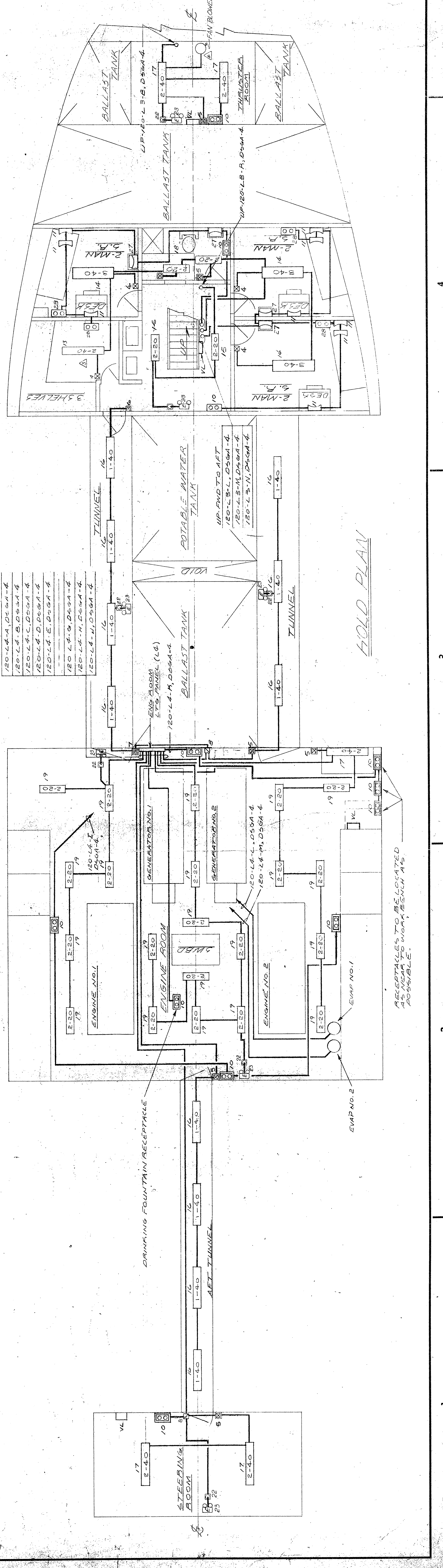

AUG 23 1973